

AVAILABLE IN THE FOLLOWING SIZES:

- 1 1/4" X 8" LONG WITH 1/2" BORE
- 1 1/4" X 10" LONG WITH 1/2" BORE
- 1 1/4" X 12" LONG WITH 1/2" BORE
- 1 1/4" X 14" LONG WITH 1/2" BORE

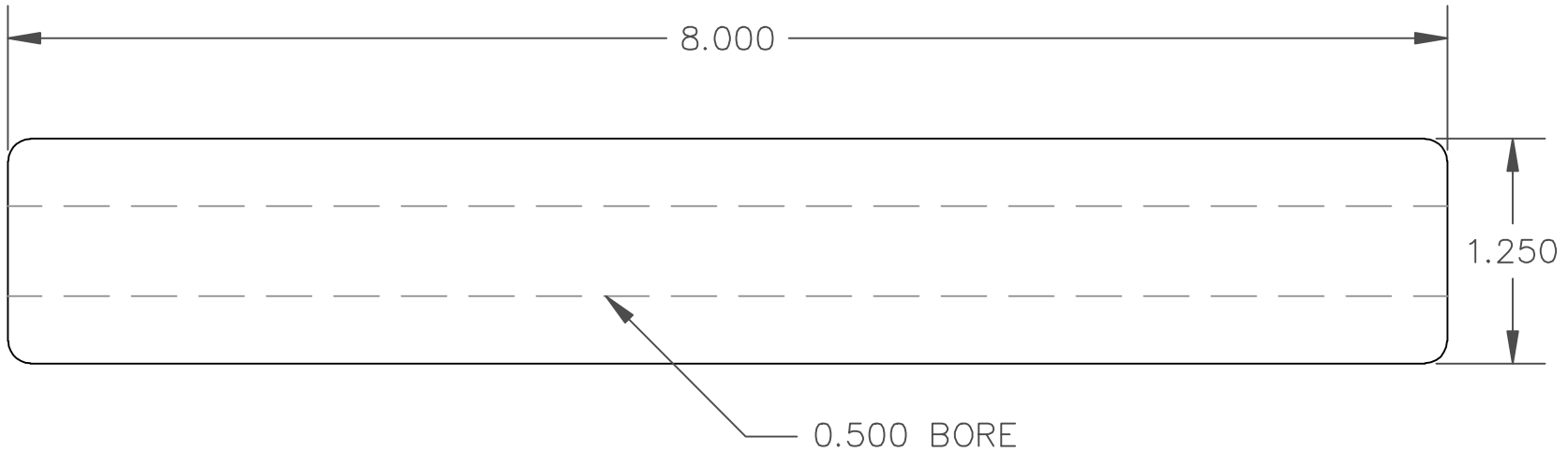

REVISION	DATE	C & D TRADING INC. 1650 FAIRWAY DR. COLUMBIA HEIGHTS MN. 55421 WWW.CDTRADINGINC.COM	HANDLE STYLE
INITIAL RELEASE			CYLINDER